

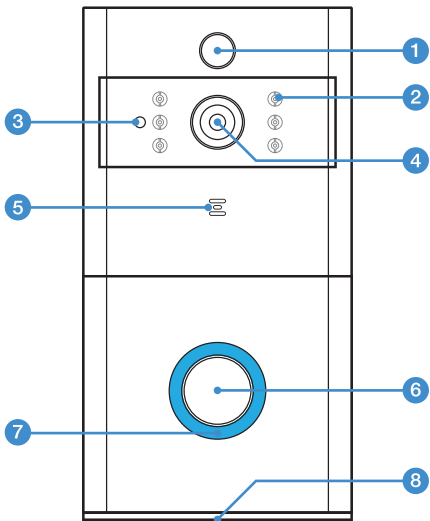

Quick Start Guide

• Product Drawing - Front



1. PIR Motion Sensor

2. Infrared LED × 6

3. Light Sensor

4. 166° HD Camera

5. Microphone

6. Push Button

7. Indicating LED

8. Speakers

• Product Drawing - Back

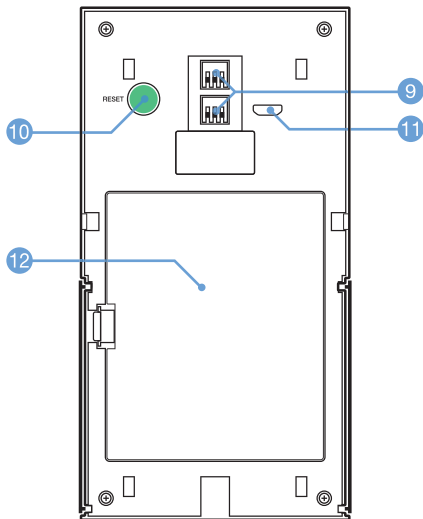

9. AC8V~24V Power Interface

10. Reset Button

11. Micro USB Port (Battery Charging)

12. Battery Compartment Cover

• Product Drawing - Mounting Bracket

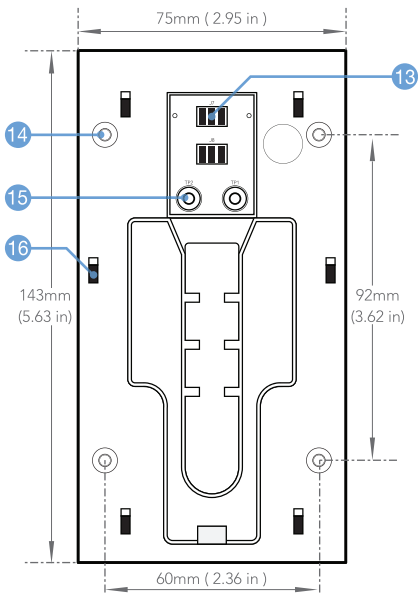

13. Power Contact Base

14. Srew Holes x 4

15. Wire Terminals

16. Mounting Hooks x 6

• Installation - Bracket Install

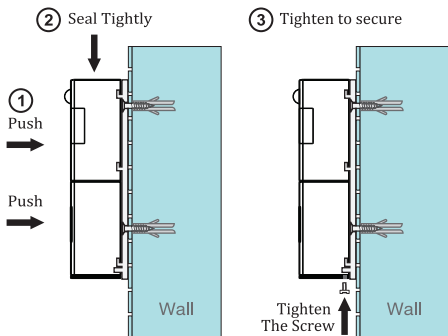
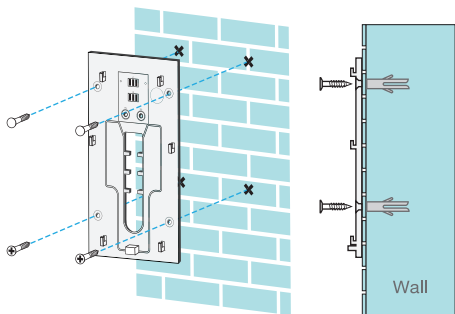

• Power Supply Solution

Hard Wire Power Source

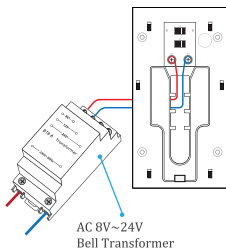

Powered by Battery

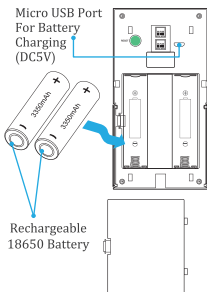

• App Download - ToSee



IOS



Android

Download the app from App Store or Google Play, run the app on your smart phone, and set up the smart video doorbell, following the in-app instructions.

First time use of the device

Step 1: Open the App, click the "+" and "Add Device";

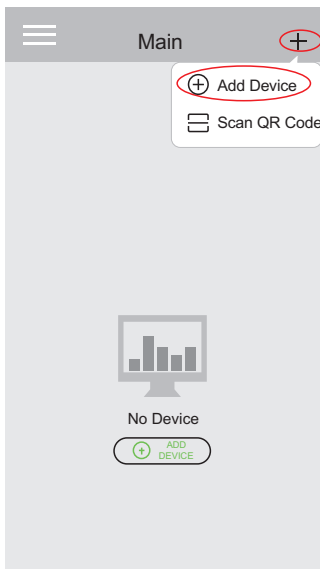

Step 2: Click "THE RED LIGHT IS FLASHING"
when the device red light flashing

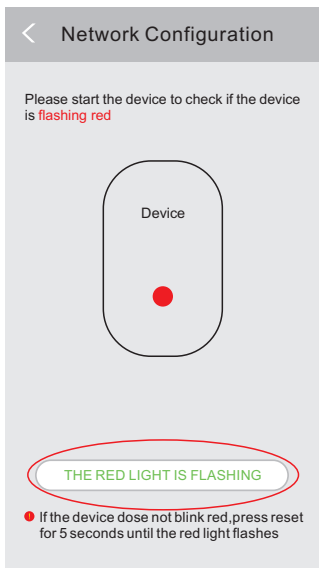

Step 3: Click “GO TO SETUP TO CONNECT DEVICE”, it will enter into your mobile phone Wi-Fi setup automatically, click to connect with your “TOSEE_...” device;

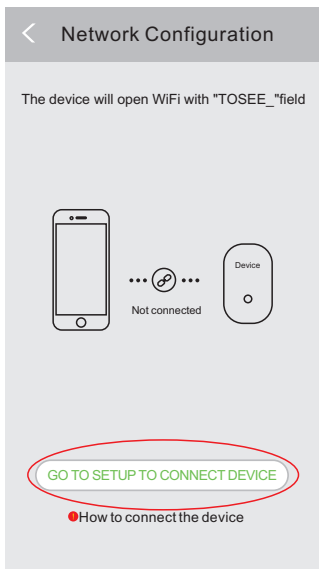

Step 4: Choose Wifi hotspot like "TOSEE_ xxxx" and then connect it.

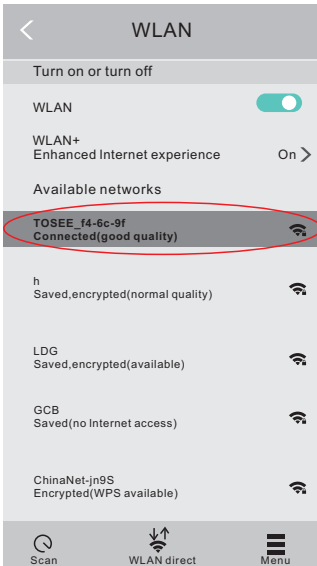

Step 5: Return to the App, and click "Next";

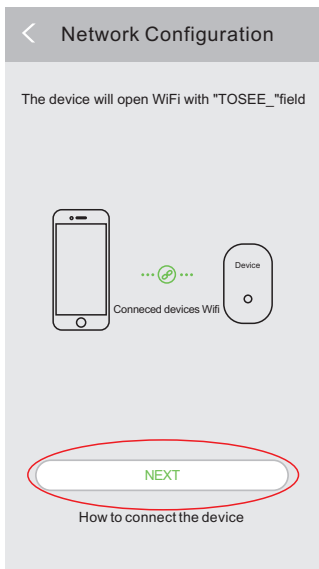

Step 6: Find your network and input the correct Wi-Fi password and click "Next";

The screenshot shows a mobile application interface for network configuration. At the top, there is a back arrow and the title "Network Configuration". Below the title, a grey box contains the text "Please configure WiFi to connect and enter WiFi password". There are two input fields: the first contains the network name "GCB" and has a plus icon on the right; the second contains the text "Please enter WiFi password" and has a plus icon and a visibility toggle icon on the right. At the bottom, there is a large rounded button labeled "NEXT" in green text. Red circles highlight the network name field, the password field, and the "NEXT" button. A large black arrow points from the right side of the screen towards the right.

Step7:Set the device's management password and click "Next";

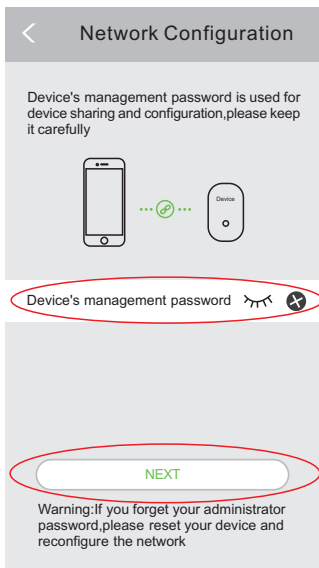

Step 8: When device added successfully, you can name your device now, and click "CONFIRM";

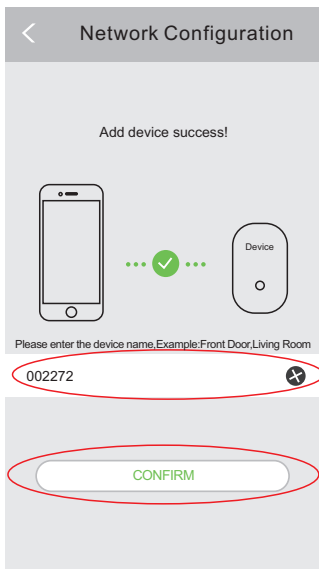

Step 9: Congrats! You can use your device now.

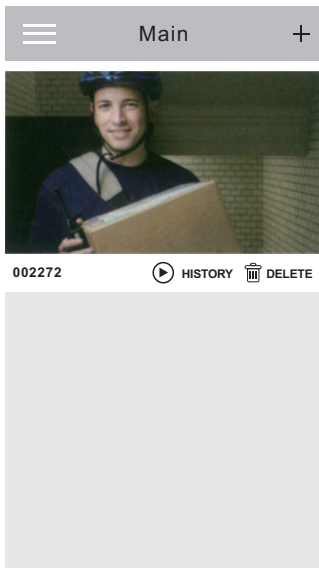

Add more users for the device

Step 1: Enter to the App's preview interface of the first user, click the “”

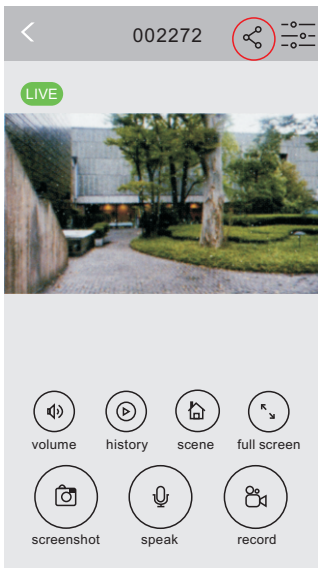

Step 2: Input the device's management password, click the "Confirm";

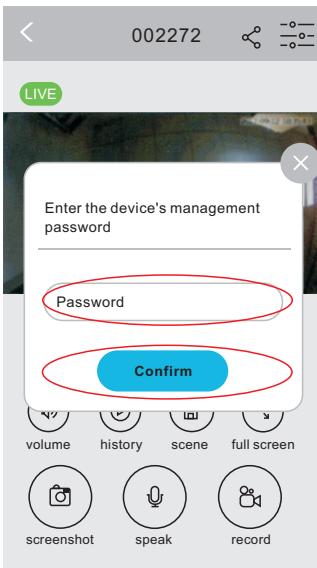

Step 3: Click the "SHARE";

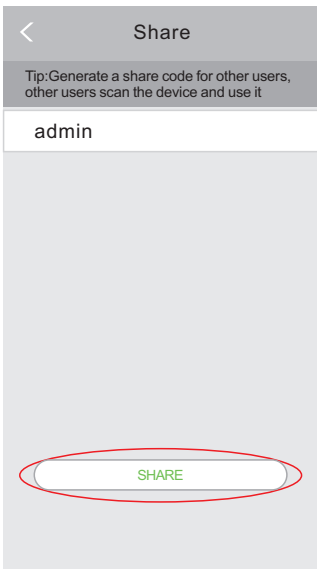

Step 4: Name the new user, and click the "Confirm";

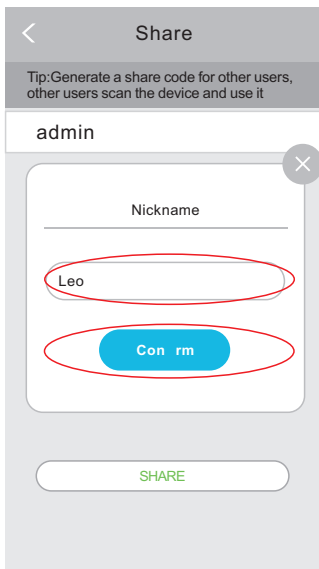

Step5: APP generates a shared QR code, new users open APP, operate as step 6, after step 6,click "Confirm" to exit the APP

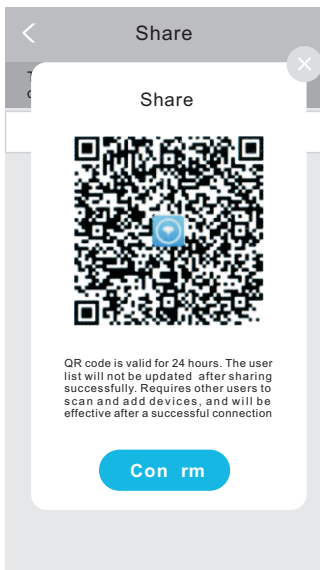

Step6: New users open the APP, click "+" and "scan code" to scan the QR code generated in the first user APP. After scanning, return to the main interface of the App, click the device interface to wake it up, and then if it shows the image means added successfully.

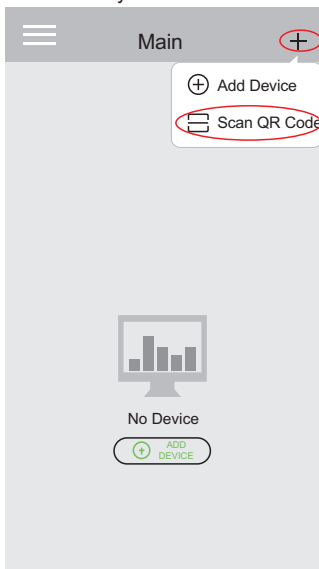

APP function introduction

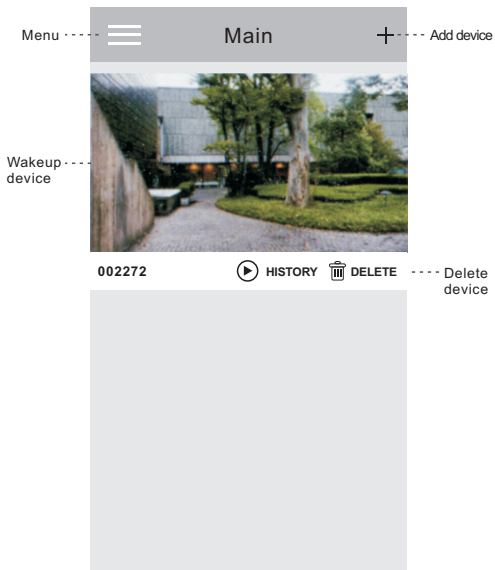

Tip: When you don't need to watch the video, please click "<" to quit from the preview interface, which can save the energy of the battery.

