

Quick Start

1. Download APP

- Scan the QR code or visit Apple APP Store or Google Play to download **CamHiPro** on your smart phone.



android



IOS

2. Adding Camera

- Connect the wireless antenna to camera and power it.
- Wait 30 seconds, go to setting and find hotspot (IPCAM-XXXXXX) from camera, enter password '01234567' to connect.

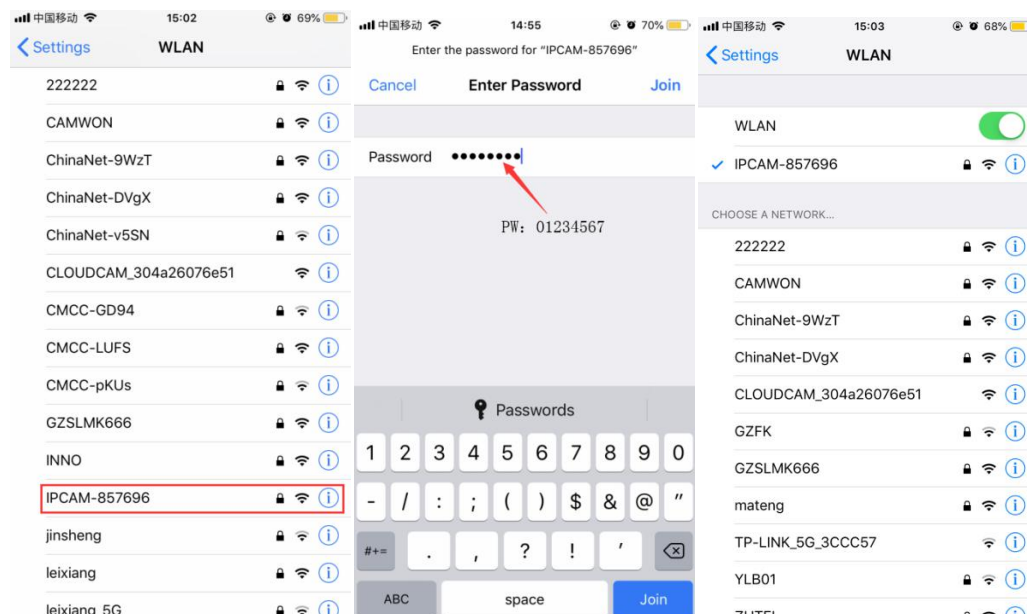

(IOS version)

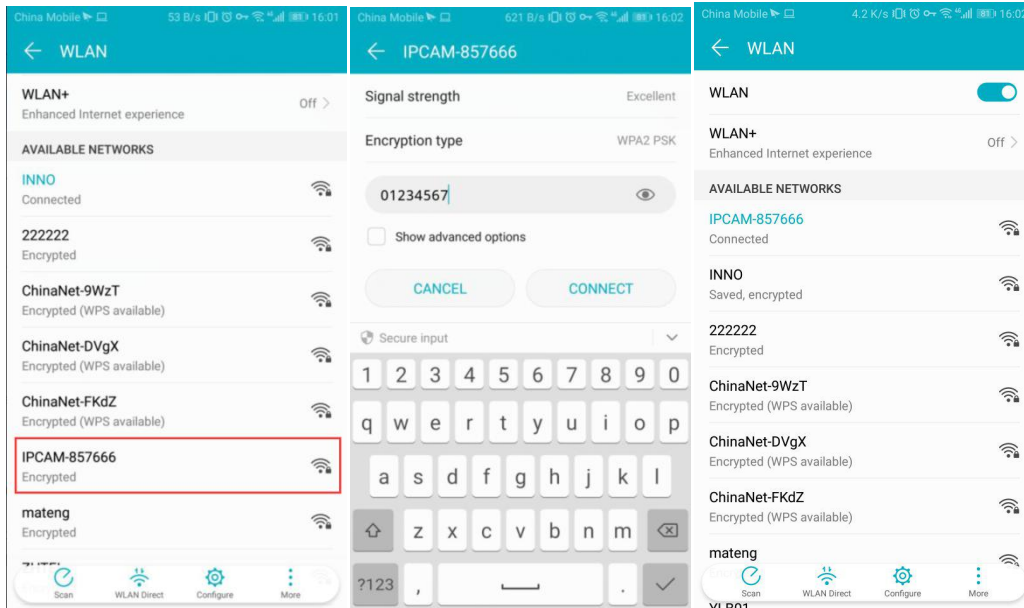

(Android version)

- Open the APP 'CamHiPro', click 'Add Camera' to add new device

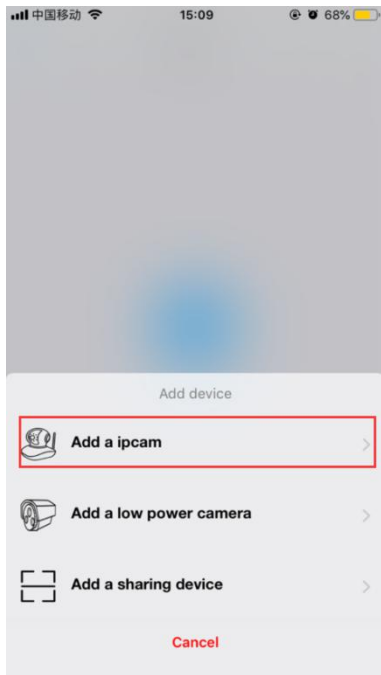

(IOS Version)

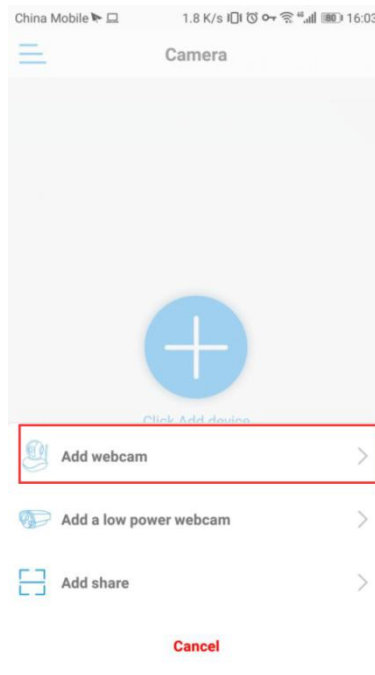

(Android Version)

● Follow the step, add 'AP equipment'

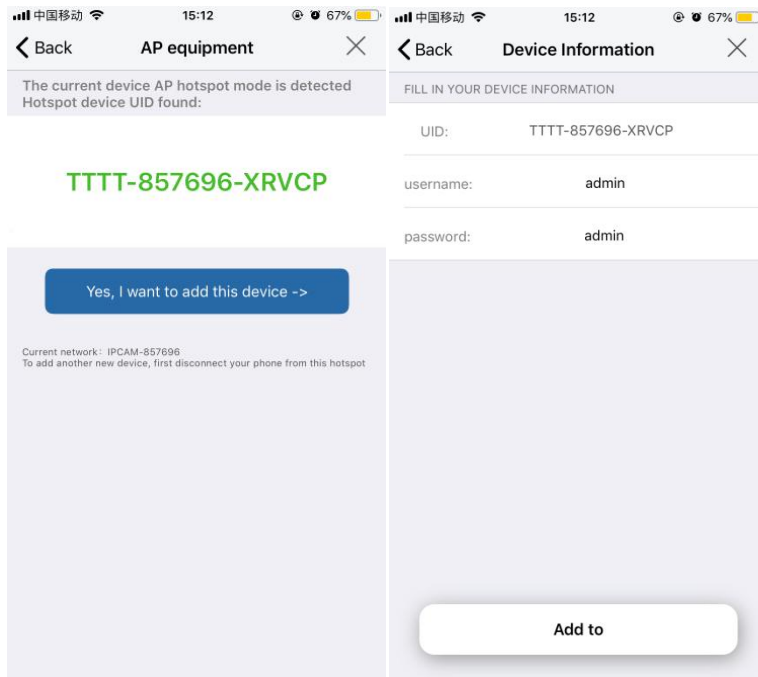

(IOS Version)

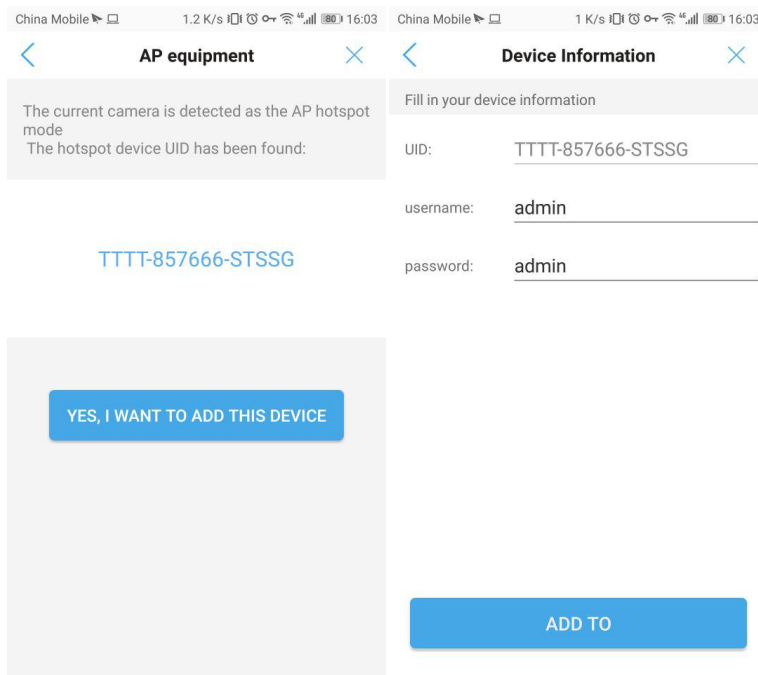

(Android Version)

- Wireless configuration, connect to your own WIFI nearby

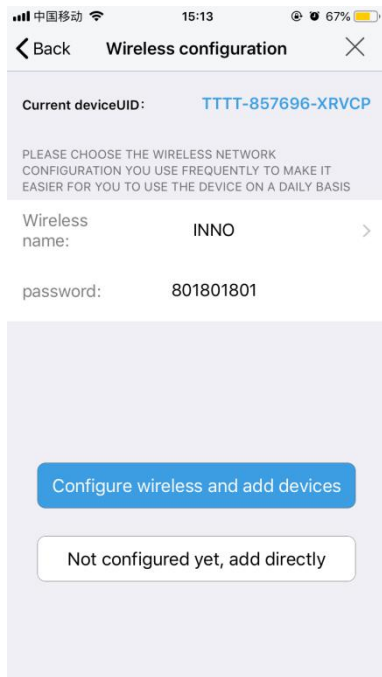

(IOS Version)

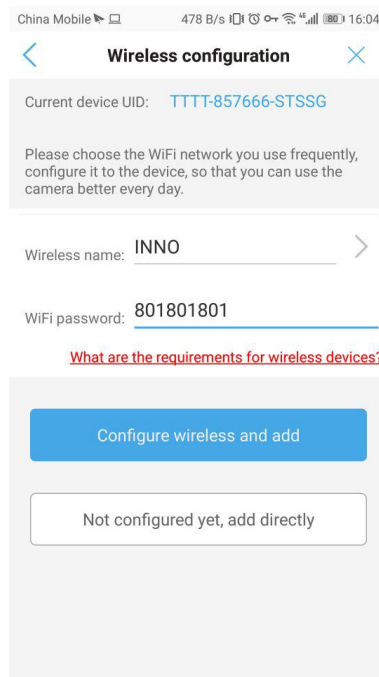

(Android Version)

- Wait 30~40 seconds, camera will connect to your WIFI automatically

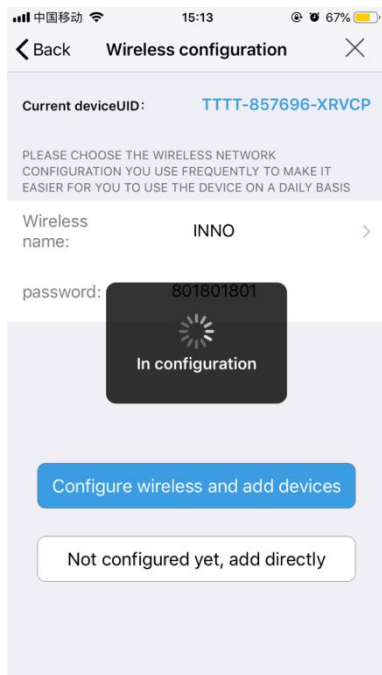

(IOS Version)

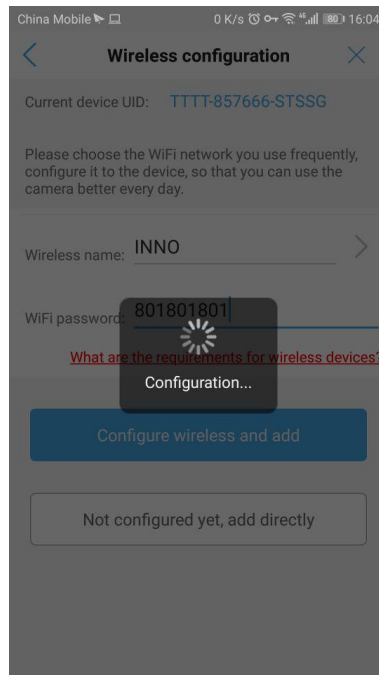

(Android Version)

● Connect camera successfully

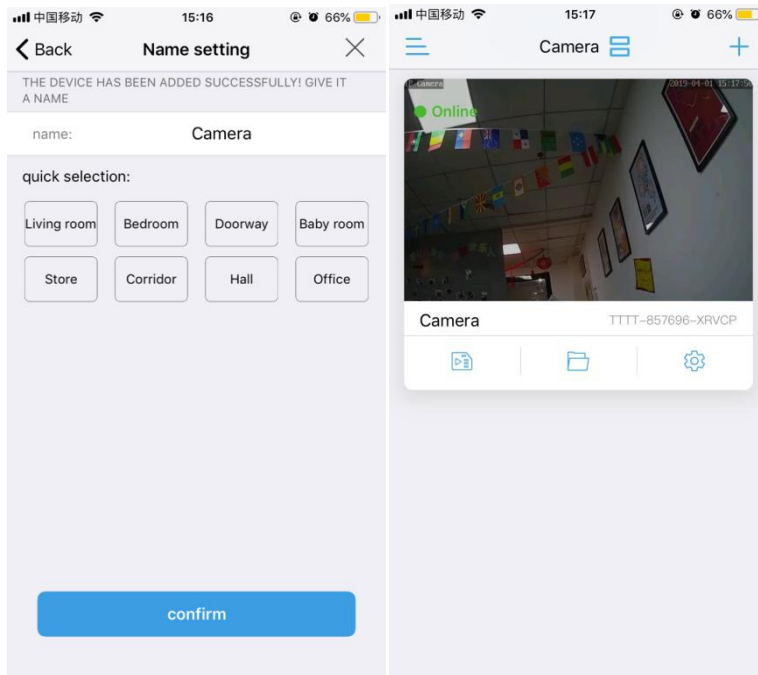

(IOS Version)

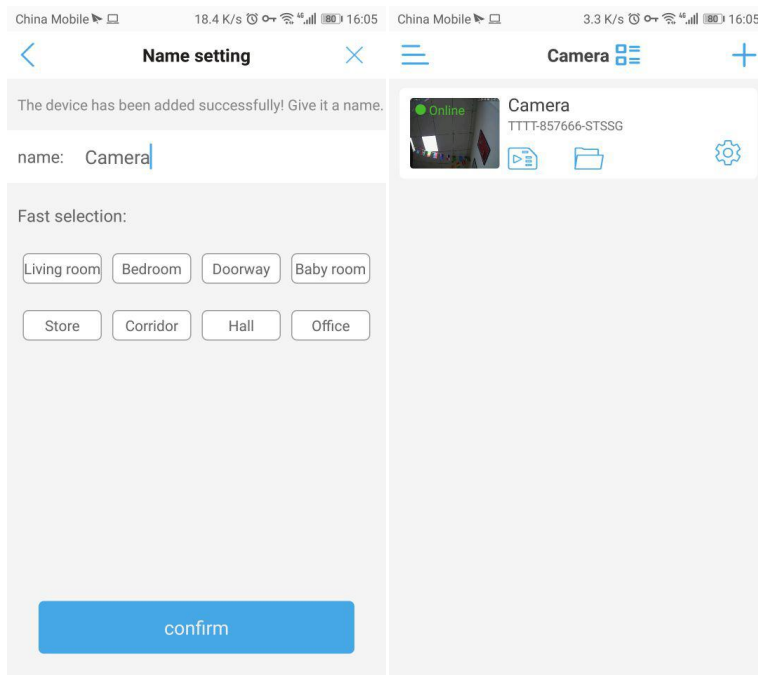

(Android Version)